



# East Lake

RESIDENTIAL COMMUNITY PARK

TUMPUNA ROAD

**HomeSolutionsTT.com**  
a Tradition of Trust

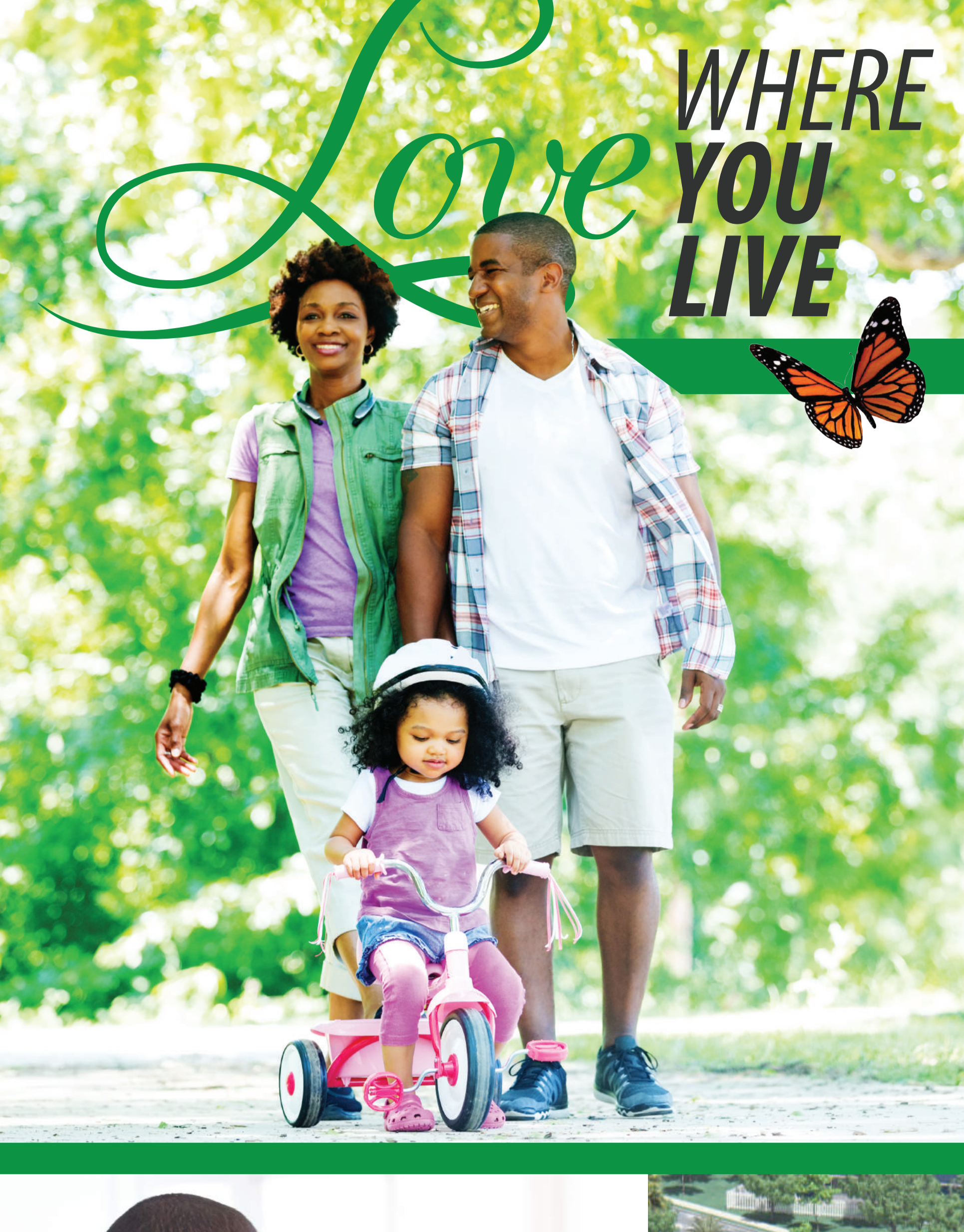

*Love* **WHERE YOU LIVE**



## Living inside & out!

East Lake Community Park is a residential oasis designed to enhance your lifestyle. An inviting gated community where you will discover carefully crafted apartments and houses which are surrounded by lush green spaces and with convenient amenities at your door step. A picturesque development of timeless design, East Lake is more than just another address.



## The Houses

Charming houses that have been designed around open plan living and opportunities for outdoor entertaining. Contemporary features and finishes on 5,000 sq ft lots will give you a vibrant quality of life surrounded by natural beauty.



**House 3 bedrooms**  
1,070 sq. ft. plus 5,000 sq. ft. lot

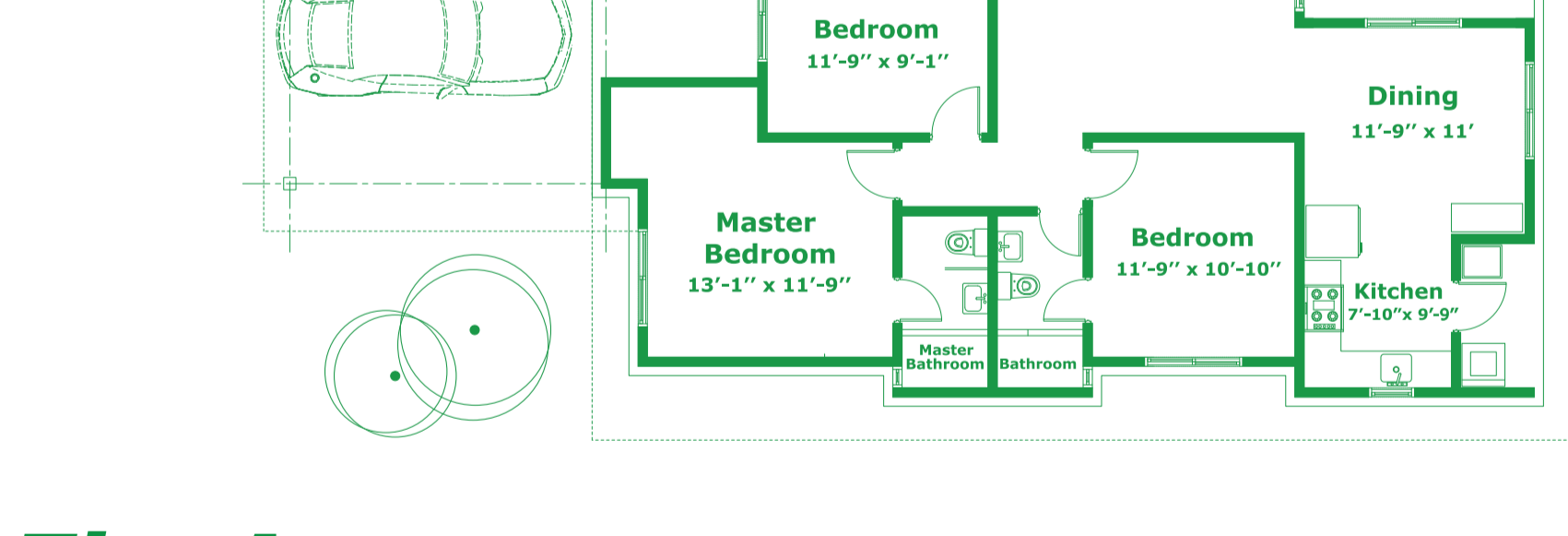

## The Apartments

Every detail is considered in our efficiently designed apartments which will leave a lasting impression with quality finishes and materials. At East Lake it's all about a lifestyle of comfort, scenic surroundings and tranquil open spaces.



**Apt A 3 bedrooms**  
1,070 sq. ft

**Apt B 3 bedrooms**  
1,070 sq. ft

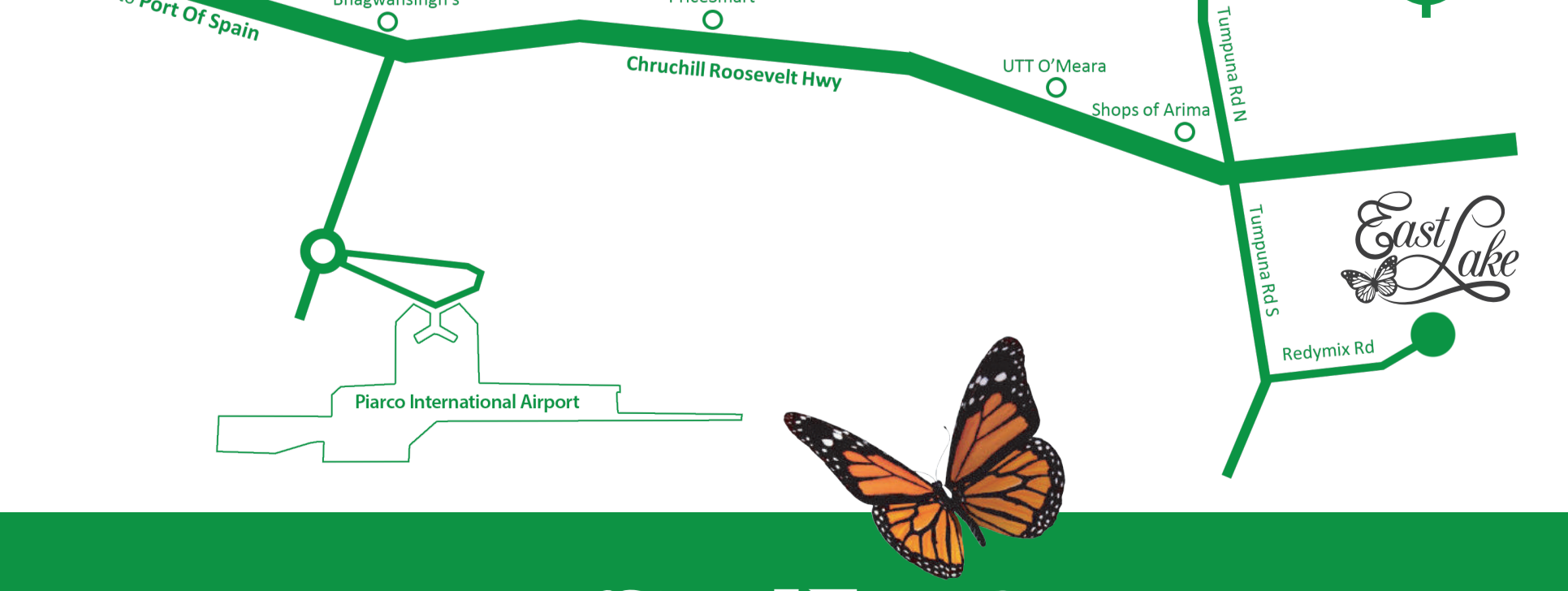
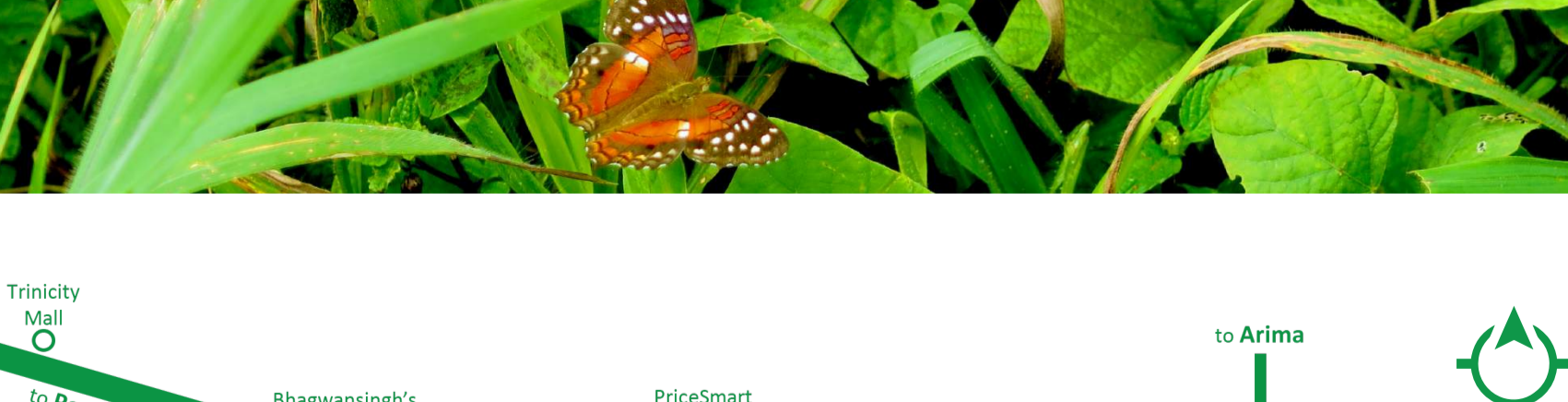
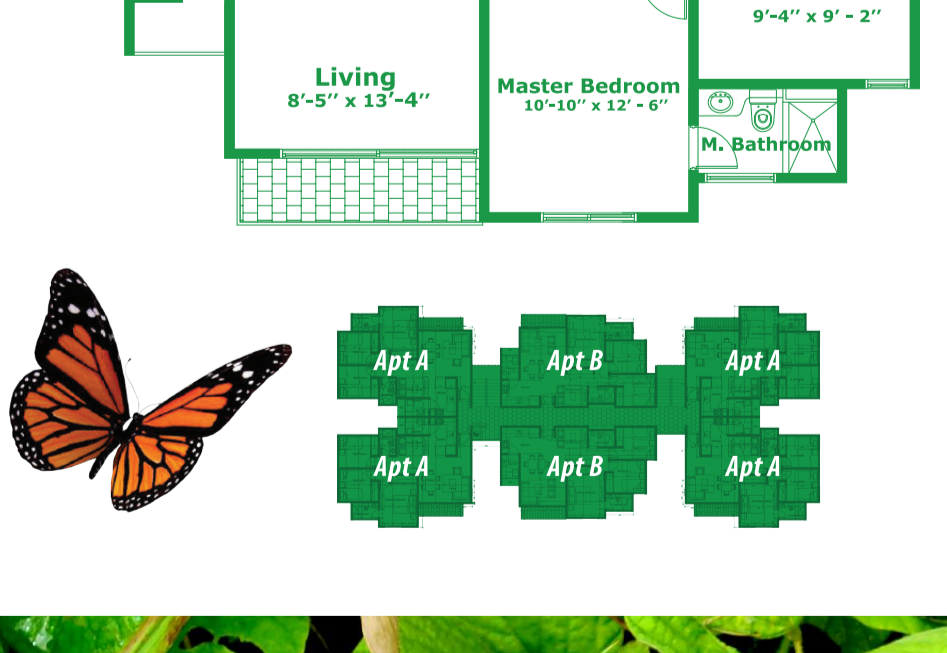
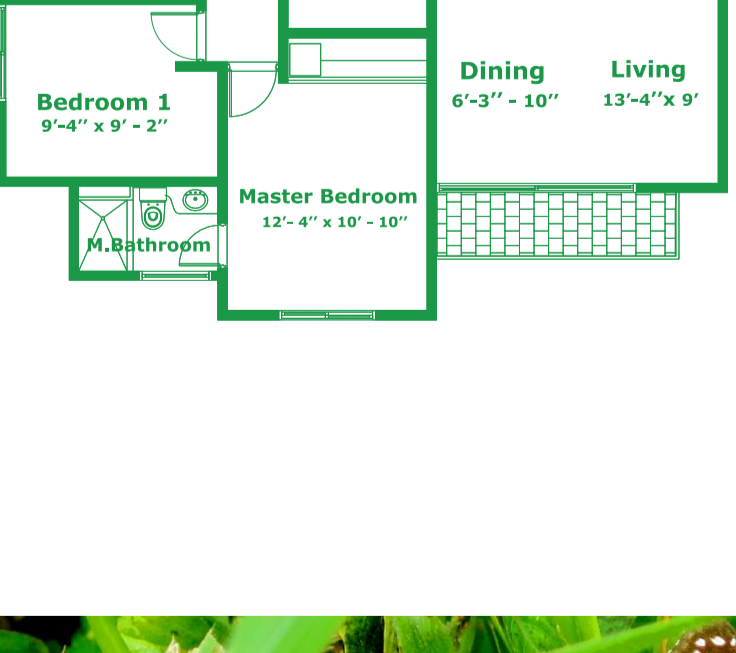

THE POINT at Tumpuna Park | Legacy at Lange Park | CARA COURT CONDOMINIUMS | WEST HILLS urban community park | Brendan's PLACE | Montrose place | ENCLAVE

**HomeSolutionsTT.com**  
a Tradition of Trust

**DINI** | **TELL GROUP** | **868 623 2257**